

LOWER FLOOR  
648 SQ.FT

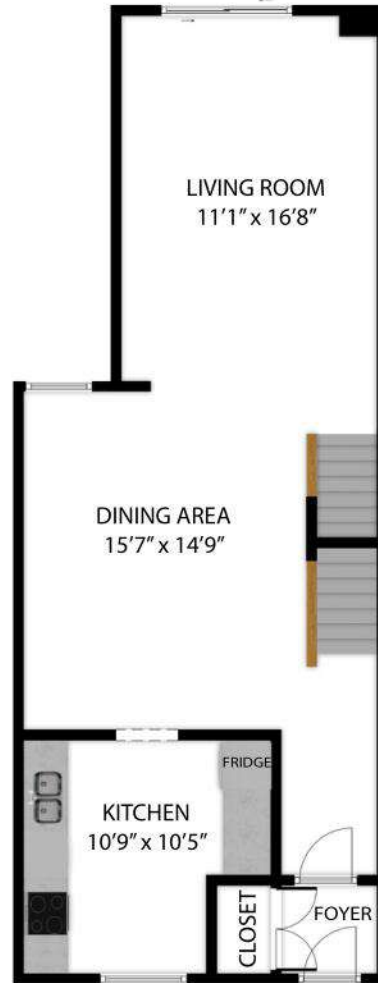

MAIN FLOOR  
647 SQ.FT

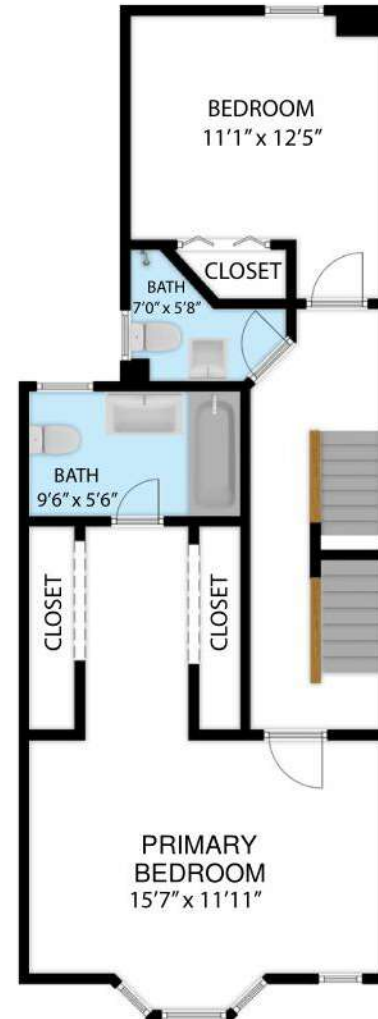

UPPER FLOOR  
657 SQ.FT

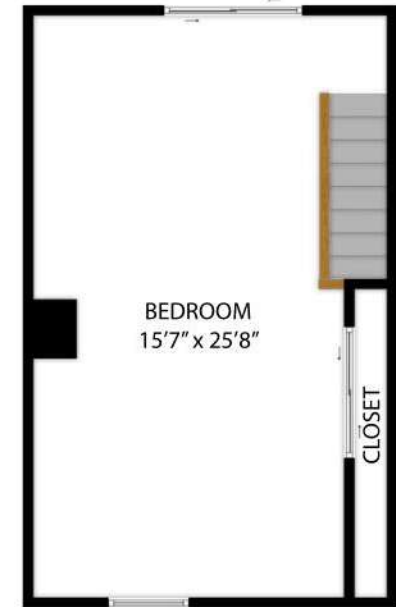

TOP FLOOR  
443 SQ.FT

320 Bain Avenue, Toronto M4J 1B8  
TOTAL APPROX. FLOOR AREA 2,395 SQ.FT

Floor plans and measurements provided are approximate and may not be 100% accurate. Floor plans are for advertising usage only and are not suitable for architecture or construction. We provide cost-effective services for property owners, managers, facility managers, real estate professionals, architects, space planners and interior designers, or any company which would like to verify their lease space size. Clients are responsible for verification and home values should not be set solely based on the floor plans.

